

(Lot Cor - Bldg Cor  
(Ext Cor Glass Walls))  
232°40'  
8.76'

**KINGSFORD SMITH DRIVE**

95.813  
66°02'20"

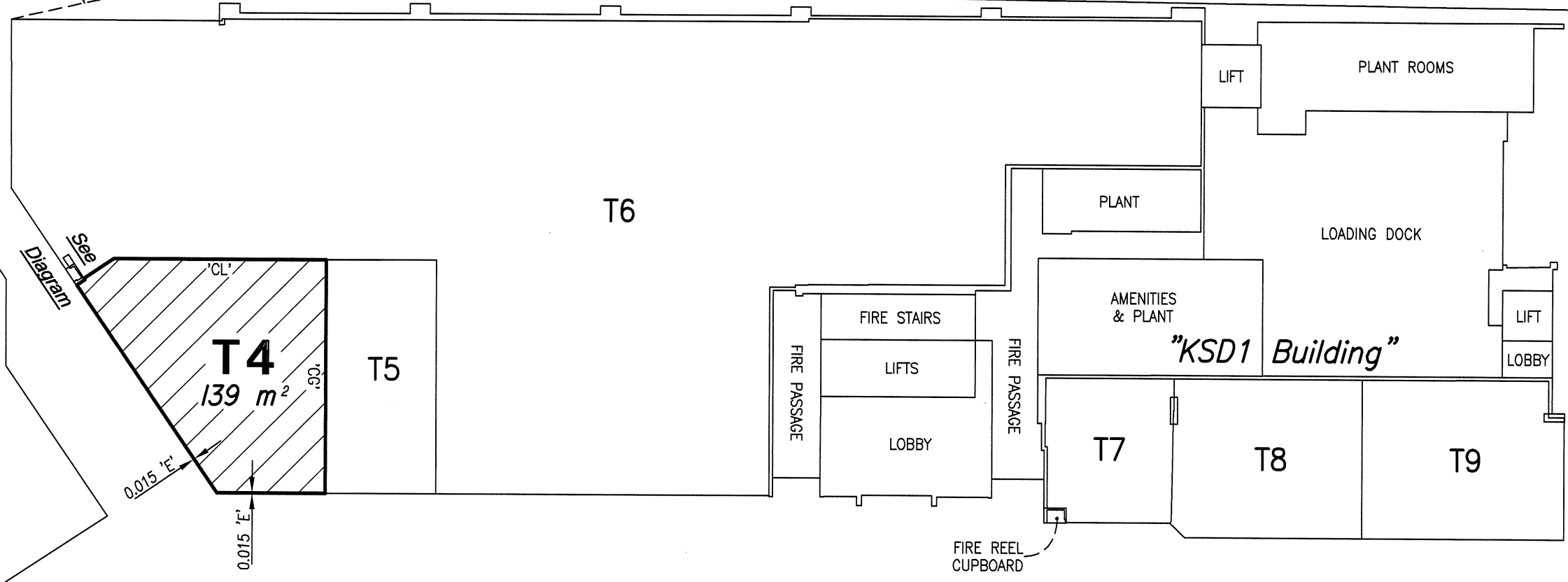

7  
SP 236563  
(Vol)

2  
SP 141869

1  
SP 131918

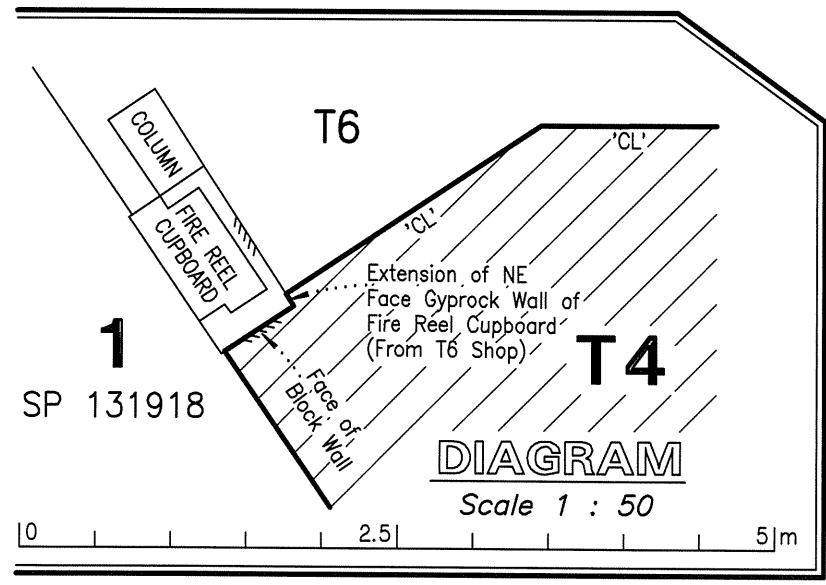

- 'E' denotes External Face of Bldg (Ext Face of Glass Wall) - Lease Bdy (Internal Face of Glass Wall)
- 'CG' denotes Centreline of Gyprock Wall
- 'CL' denotes Centreline of Block Wall

**PLAN FOR LEASE PURPOSES**

Over part of the Ground Floor of a building situated on the land contained in the Certificate of Title 50907477 Being Lot 1 on SP 131918 Parish of Toombul County of Stanley Locality of Hamilton.

**Note**  
Lease area is a "Gross Lettable Area-Retail" as defined in the Property Council of Australia's "Method of Measurement for Lettable Area" (©1997).

Lease area defined by structural elements being the internal face of glass walls unless shown otherwise.

For clarity only adjoining information that exists at this floor level is shown.

Lease area shown hatched.

Tenancy surveyed: 22/03/2013.

DWG: 22151-5\_KSD1\_LEA-GND.dwg

Surv:	WJB	Scale:	1 : 300 @ A3
Date:	03/04/2013	Ref #	22151-67

We, RPS Australia East Pty Ltd (ACN 140 292 762), Cadastral Surveyor, certify that the details shown on this sketch plan are correct.

*[Signature]*  
Authorized Delegate  
8.A.13  
Date



© COPYRIGHT PROTECTS THIS PLAN  
Unauthorized reproduction or amendment not permitted. Please contact the author.

RPS Australia East Pty Ltd  
ACN 140 292 762  
ABN 44 140 292 762  
743 Ann Street  
PO Box 1559  
Fortitude Valley QLD 4006  
T +61 7 3237 8899  
F +61 7 3237 8833  
W rpsgroup.com.au