

**WHARF STREET**

Emt A (Vol) SPI41278

Cor Bldg 0-10°W, 0-38°W

**STREET**

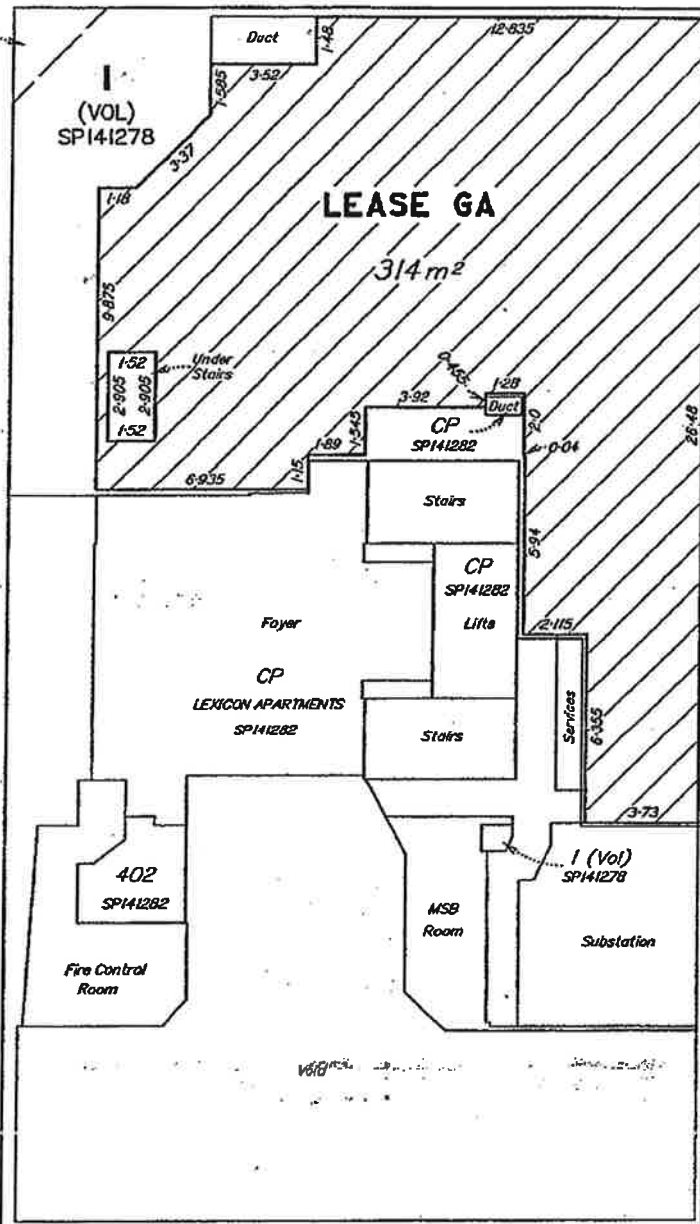

9  
RP92926

AREA OF LEASE SHOWN HACHURED.

Areas include columns and parts of walls.

**NOTE:**  
PROPERTY COUNCIL OF AUSTRALIA (MARCH 1997) NET LETTABLE AREA: MEASUREMENTS TAKEN TO INSIDE FACE OF EXTERNAL GLASS (BEING THE DOMINANT PORTION OF THE EXTERNAL WALLS).

**ANN STREET**

Cor Bldg 0-15°E, 0-43°E

CP BUP103792 IS119545

Common Property of Lexicon Apartments CIS 707583095 (SP141282)

**LEVEL E ON SP141282**

Scale 1:150 - Lengths are in Metres.



NORRIS CLARKE & O'BRIEN PTY LTD Coastal Surveyors (ACN 056 870 770) hereby certify that the details shown on this sketch plan are correct.

Director and Cadastral Surveyor

Date.....

"ACCREDITED SURVEYOR"

"SKETCH OK"

Description  
**LEASE GA (Being part of the GROUND floor of a building) in LOT 1 on SP141278 Parish of NORTH BRISBANE County of Stanley**

Scale in Metres. **1:150 at A3**

**Norris Clarke & O'Brien Pty Ltd**  
Licensed Surveyors  
Town Planners  
Development Consultants

Unit 2-107 Quay Street  
Brisbane QLD 4000  
ph 3221 9649 fax 3221 3391  
email ncosurv@powerup.com.au  
ACN 056 870 770 ABN 15 056 870 770

Title Ref. **50486868**

Date **08/11/2004** Ref. **6709L-GA**

WHARF STREET

STREET

ANN STREET

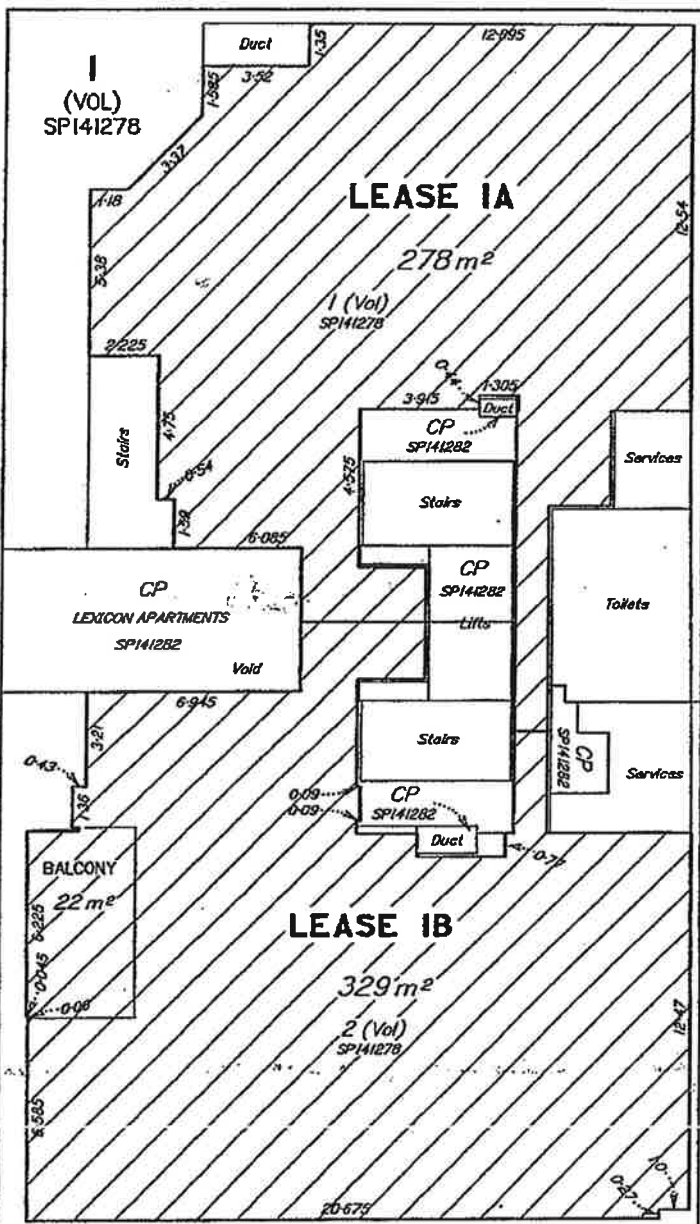

Cor Bldg  
0-10°N, 0-38°W

TITLE REF	LEASE AREAS
50486868 (LOT 1)	278 m <sup>2</sup>
50486869 (LOT 2)	329 m <sup>2</sup>
<b>TOTAL LEASE AREA</b>	<b>607 m<sup>2</sup></b>

9  
RP92926

NOTE: - LEASE AREAS ARE SUBJECT TO SURVEY TOTAL AREA OF 607m<sup>2</sup> INCLUDES BALCONY DRAFT 20/04/2005.

AREA OF LEASE SHOWN HACHURED.

Areas include columns and parts of walls.

NOTE: PROPERTY COUNCIL OF AUSTRALIA (MARCH 1997) NET LETTABLE AREA. MEASUREMENTS TAKEN TO INSIDE FACE OF EXTERNAL GLASS (BEING THE DOMINANT PORTION OF THE EXTERNAL WALLS).

CP BUP103792 ISH19545

Common Property of Lexicon Apartments CTS 707583095 (SP141282)

LEVEL F ON SP141282

Scale 1:150 - Lengths are in Metres.



NORRIS CLARKE & O'BRIEN PTY LTD Cadastral Surveyors, (ACN 056 870 770) hereby certify that the details shown on this sketch plan are correct.

Director and Cadastral Surveyor

Date

"ACCREDITED SURVEYOR" "SKETCH OK"

Description  
LEASE 1A & 1B (Being part of the FIRST floor of a building) in LOT 1 & 2 on SP141278 Parish of NORTH BRISBANE County of Stanley

Scale in Metres. 1:150 at A3

Norris Clarke & O'Brien Pty Ltd

Licensed Surveyors  
Town Planners  
Development Consultants

Unit 2 - 107 Quay Street  
Brisbane QLD 4000  
ph 3221 8649 fax 3221 3391  
email ncosurv@powerup.com.au  
ACN 056 870 770 ABN 15 056 870 770

Title Ref. 50486868 & 50486869

Date 20/4/2005 Ref. 6709L-1A

**WHARF STREET**

**STREET**

**ANN**

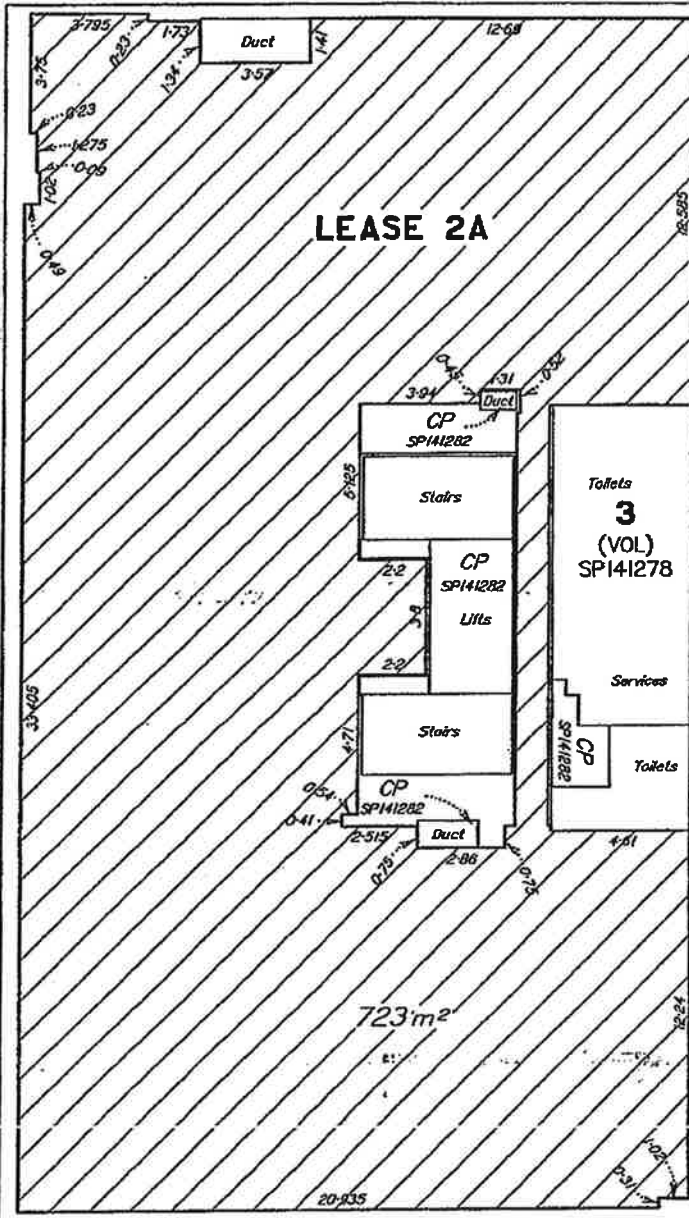
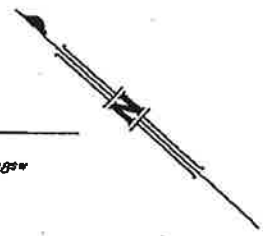

Cor Bldg  
0-104W, 0-385W

9  
RP92926

NOTE: - LEASE AREAS  
ARE SUBJECT TO SURVEY

DRAFT 20/04/2005.

AREA OF LEASE  
SHOWN HATCHURED.

Areas include columns  
and parts of walls.

NOTE:  
PROPERTY COUNCIL OF AUSTRALIA  
(MARCH 1997) NET LETTABLE AREA.  
MEASUREMENTS TAKEN TO INSIDE  
FACE OF EXTERNAL GLASS  
(BEING THE DOMINANT PORTION  
OF THE EXTERNAL WALLS).

Cor Bldg  
0-154E, 0-435NE

CP BUP103792  
15119545

Common Property of Lexicon  
Apartments CTS 707583095 (SP141282)

LEVEL G ON SP141282

Scale 1:150 - Lengths are in Metres.



NORRIS CLARKE & O'BRIEN PTY LTD Cadastral  
Surveyors, (ACN 056 870 770) hereby certify  
that the details shown on this sketch plan are  
correct.

Director and Cadastral Surveyor

Date.....

"ACCREDITED SURVEYOR"

"SKETCH OK"

Description

LEASE 2A (Being part of the SECOND  
floor of a building) in  
LOT 3 on SP141278  
Parish of NORTH BRISBANE  
County of Stanley

Scale in Metres.

1:150 at A3

Norris Clarke & O'Brien Pty Ltd



Licensed Surveyors  
Town Planners  
Development Consultants

Unit 2 - 107 Quay Street  
Brisbane QLD 4000  
ph 3221 9649 fax 3221 3391  
email ncosurv@powerup.com.au  
ACN 056 870 770 ABN 15 056 870 770

Title Ref.

50486870

Date

20/4/2005 Ref. 6709L-2A

**WHARF STREET**

**STREET**

**ANN**

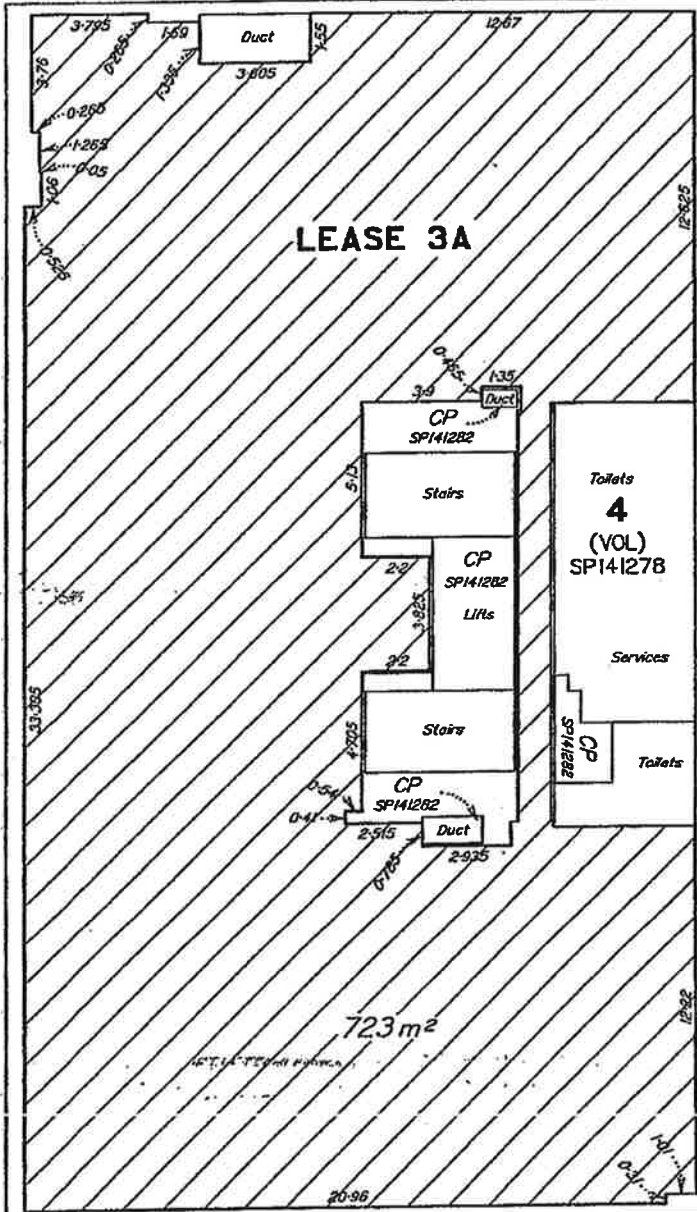

Cor Bldg  
0-10NW, 0-38SW

9  
RPS2926

NOTE: - LEASE AREAS  
ARE SUBJECT TO SURVEY

DRAFT 20/04/2005.

AREA OF LEASE  
SHOWN HATCHED.

Areas include columns  
and parts of walls.

NOTE:  
PROPERTY COUNCIL OF AUSTRALIA  
(MARCH 1997) NET LETTABLE AREA.  
MEASUREMENTS TAKEN TO INSIDE  
FACE OF EXTERNAL GLASS  
(BEING THE DOMINANT PORTION  
OF THE EXTERNAL WALLS).

Cor Bldg  
0-15NE, 0-43SE

CP BU103792  
15119545

Common Property of Lexicon  
Apartments CTS 707583095 (SP141282)

LEVEL H ON SP141282

Scale 1:150 - Lengths are in Metres.



NORRIS CLARKE & O'BRIEN PTY LTD Cadastral  
Surveyors, (ACN 056 870 770) hereby certify  
that the details shown on this sketch plan are  
correct.

Director and Cadastral Surveyor

Date

"ACCREDITED SURVEYOR"

"SKETCH OK"

Description  
LEASE 3A (Being part of the THIRD  
floor of a building) in  
LOT 4 on SP141278  
Parish of NORTH BRISBANE  
County of Stanley

Scale in Metres. 1:150 at A3

Norris Clarke & O'Brien Pty Ltd

**NCB** Licensed Surveyors  
Town Planners  
Development Consultants

Unit 2 - 107 Quay Street  
Brisbane QLD 4000  
ph 3221 8648 fax 3221 3391  
email ncosurv@powerup.com.au  
ACN 056 870 770 ABN 15 056 870 770

Title Ref. 50486871

Date 20/4/2005 Ref. 6709L-3A