

REFERENCE MARKS

| STN | TO | ORIGIN | BEARING | DIST |
|-----|---------------------|------------|------------|--------|
| 1 | O.Gl Nail in Path | 2/1S210190 | 262°05' | 2-051 |
| 1 | Nail in Kerb | | 304°16'20" | 3-955 |
| 1 | O.Screw in R/Bout | 2/1S210190 | 306°27'30" | 13-747 |
| 1 | O.Nail in R/Bout | 2/1S210190 | 291°04'30" | 14-83 |
| 2 | OIP gone | 25/883829 | at Station | |
| 2 | O.Nail in Path | 7/1S210190 | 23°42' | 4-168 |
| 3 | O.Nail in Kerb | 8/1S210190 | 69°33' | 5-892 |
| 3 | Nail in Kerb | | 98°57' | 6-168 |
| 4 | O.Nail in Kerb | 5/1S210190 | 203°04' | 7-33 |
| 5 | Nail in Path | | 257°00'30" | 23-835 |
| 5 | O.Nail in Path gone | 4/1S210190 | 212°14' | 3-244 |
| 6 | O.Nail in Kerb gone | 3/1S210190 | 258°17' | 4-096 |
| 6 | O.Nail in Kerb gone | 3/1S210190 | 311°13' | 6-660 |

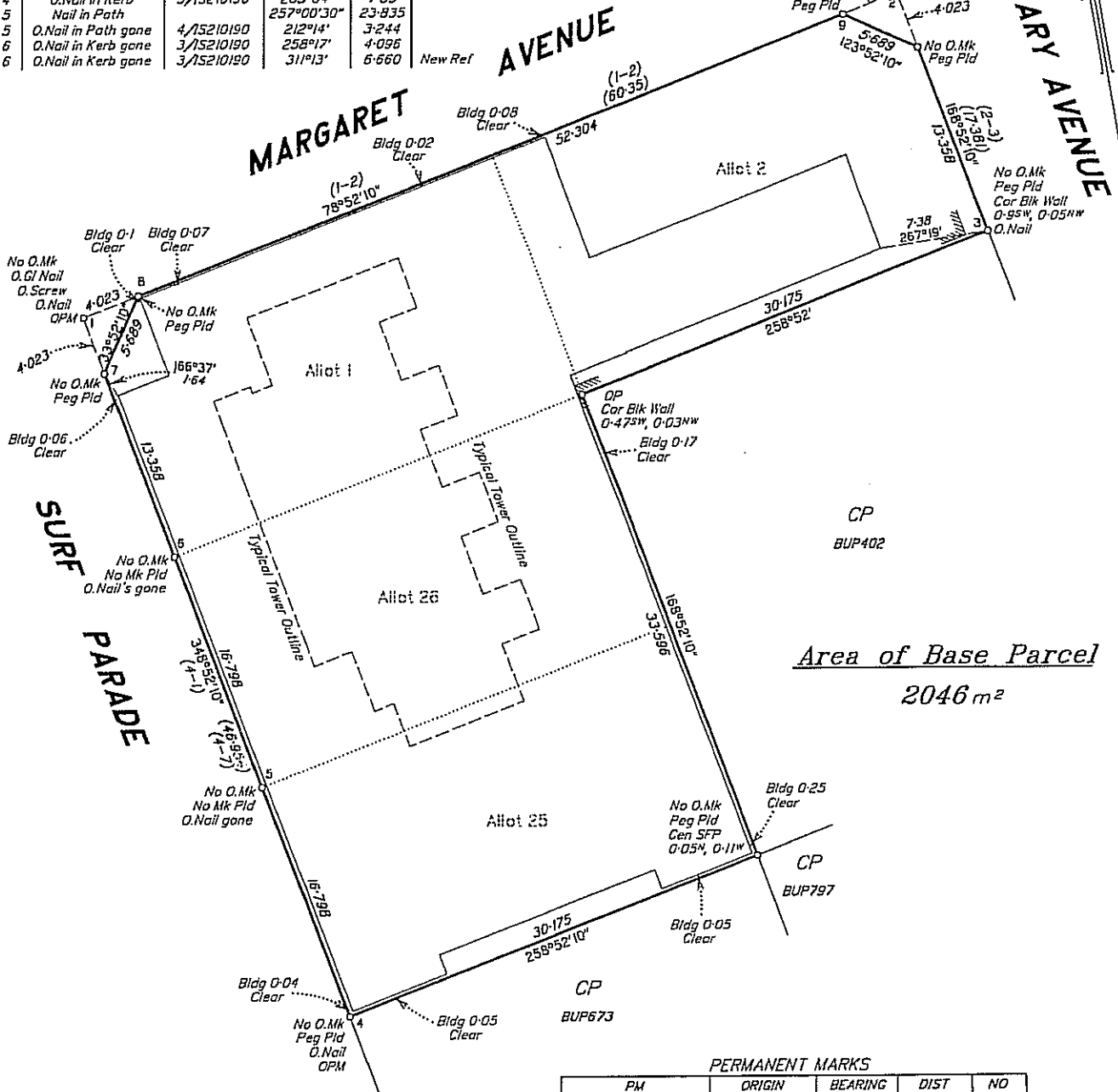

Area of Base Parcel
2046 m²

PERMANENT MARKS

| PM | ORIGIN | BEARING | DIST | NO |
|-------|-----------|------------|---------|------|
| 1-OPM | 8/883827 | 348°52'10" | 28-164 | 949 |
| 4-OPM | 20/883829 | 168°52'10" | 155-555 | 1124 |

B.B.H. PTY. LTD. (ACN 010 427 531) hereby certify that the land comprised in this plan was surveyed by the corporation, by Craig John Purdon, Surveying Associate for whose work the corporation accepts responsibility, under the supervision of Stephen William Mavor, Cadastral Surveyor, and that the plan is accurate, that the said survey was performed in accordance with the Survey and Mapping Infrastructure Act 2003 and Surveyors Act 2003 and associated Regulations and Standards and that the said survey was completed on 23/07/2008.

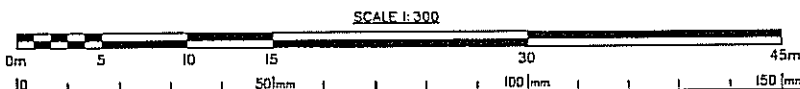

Plan of Lots 1, 11-14, 21-24, 31-34, 41-44, 51-54, 61-64, 71-74, 81-84, 91-94, 101-104, 111-114, 121-124, 131-134, 141-144, 151-154, 161-164, 171-174, 181-184, 191-194, 201 & Common Property

Cancelling Lots 31,55 & 56 on B83829 & Lot 30 on SP199737

PARISH: GILSTON COUNTY: Ward

Meridian: 1S210190 F/N's: No

Scale: 1:300

Format: BUILDING

SP199740

Plan Status:

BERNIETT & BERNIETT CG. 476 (06-4766FP-E.DWG) MCH Rev 14/7/08

WARNING : Folded or Mutilated Plans will not be accepted.
Plans may be rolled.
Information may not be placed in the outer margins.

Withdrawn 3-11-08
reentered

~~719887220~~
712021977
\$5812.00
\$5812.00
03/11/2008 07:53

Registered

s. Lodged by
Matthews Property Group
Po Box 129
Mooloolaba Q 4557
07 5477 7494
B Just
(Include address, phone number, reference, and Lodger Code) **803**

NR 400 NT

1. Certificate of Registered Owners or Lessees.

I/We **BLACKBEAN PTY LTD**
A.C.N. 010.698.030

(Names in full)

* as Registered Owners of this land agree to this plan and dedicate the Public Use Land as shown hereon in accordance with Section 50 of the Land Title Act 1994.

* as Lessees of this land agree to this plan.

Signature of *Registered Owners *Lessees

Lawry James Matthews
Sales Director

| Title Reference | Lot | Plan | Created | | |
|-----------------|-----|----------|--|------|------|
| | | | Lots | Emts | Road |
| 13787177 | 55 | B83829 | 1,14,24,34,44,54,64,74,84,94,104,114,124,134,144,154,164,174,184,194,201 & CP | | |
| 13563098 | 56 | B83829 | 1,12-14,22-24,32-34,42-44,52-54,62-64,72-74,82-84,92-94,102-104,112-114,122-124,132-134,142-144,152-154,162-164,172-174,182-184,192-194,201 & CP | | |
| 14398206 | 31 | B83829 | 1,11,12,21,22,31,32,41,42,51,52,61,62,71,72,81,82,91,92,101,102,111,112,121,122,131,132,141,142,151,152,161,162,171,172,181,182,191,192,201 & CP | | |
| 50685986 | 30 | SP199737 | CP | | |

For Mortgage Allocation Table, See Sheet 10

For Portion Allocation Table, See Sheet 10

* Rule out whichever is inapplicable

2. Local Government Approval.

* **COUNCIL OF THE CITY OF GOLD COAST**

hereby approves this plan in accordance with the :

% **INTEGRATED PLANNING ACT 1997**

Dated this 20th day of October 2008

David Andrew Lohaar
Authorising Officer

* Insert the name of the Local Government. % Insert Integrated Planning Act 1997 or # Insert designation of signatory or delegation Local Government (Planning & Environment) Act 1990

3. Plans with Community Management Statement :

CMS Number : **39184**
Name : **OCEAN PACIFIC**

4. References :

Dept File :
Local Govt : **AV16036/06/01**
Surveyor : **06.476**

Development Approval: 11/07/2007

12. Building Format Plans only.

I certify that :
* As far as it is practical to determine, no part of the building shown on this plan encroaches onto adjoining lots or road;
* Part of the building shown on this plan encroaches onto adjoining lots and road.

[Signature] **8.9.08**
Cadastral Surveyor/Director * Date
* delete words not required

| Lots | Orig |
|--|------|
| 7. Portion Allocation : | |
| 8. Map Reference : 9541-11421 | |
| 9. Locality : BROADBEACH | |
| 10. Local Government : GOLD COAST CITY COUNCIL | |
| 11. Passed & Endorsed : By: B.B.H. PTY. LTD. ACN D10 427 531 Date: 8.9.08 21.10.08 Signed: <i>[Signature]</i> Designation : Cadastral Surveyor | |

| 13. Lodgement Fees : | |
|----------------------|----------|
| Survey Deposit | \$ |
| Lodgement | \$ |
| New Titles | \$ |
| Photocopy | \$ |
| Postage | \$ |
| TOTAL | \$ |

14. Insert Plan Number **SP199740**

LEVEL A

(Lower Basément)
Scale 1:200

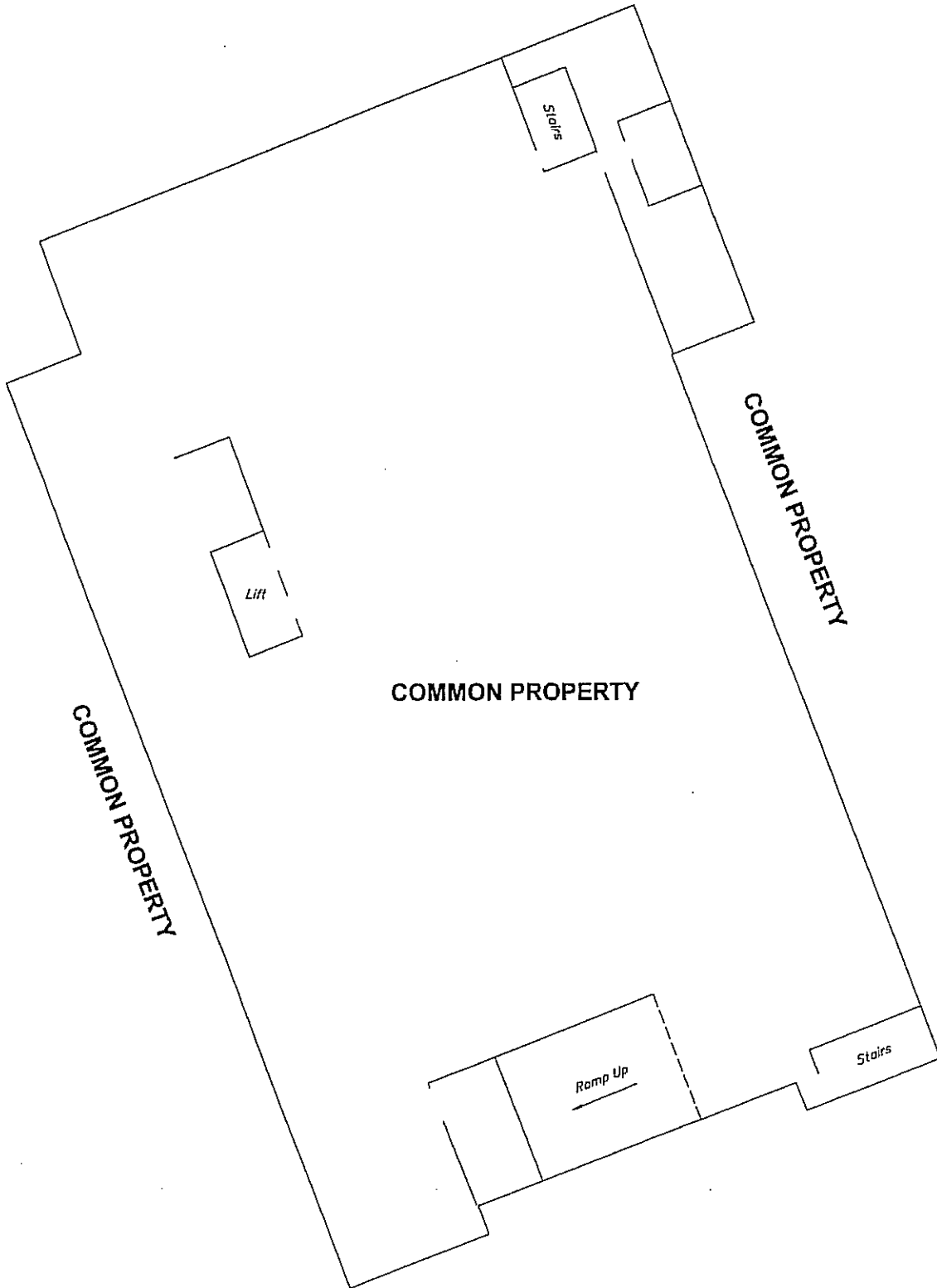

COMMON PROPERTY

COMMON PROPERTY

COMMON PROPERTY

SCALE 1:200

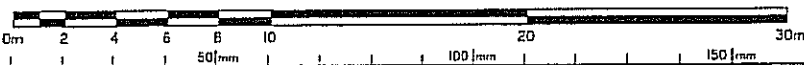

State copyright reserved.

Insert
Plan
Number **SP199740**

LEVEL B

(Upper Basement)
Scale 1:200

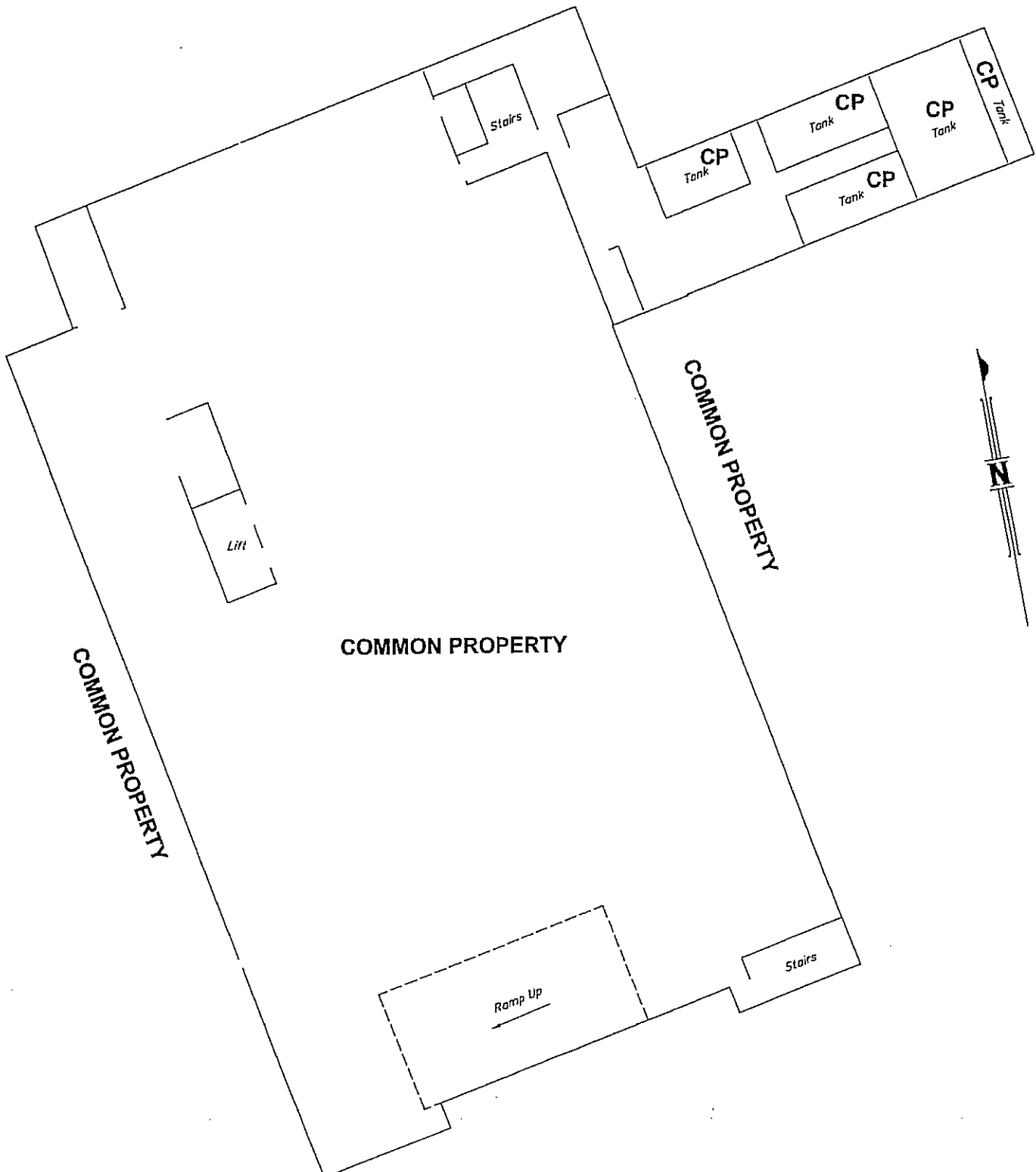

COMMON PROPERTY

COMMON PROPERTY

COMMON PROPERTY

SCALE 1:200

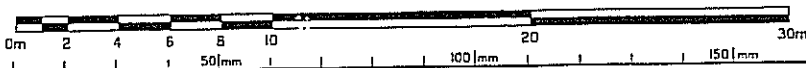

State copyright reserved.

Insert Plan Number **SP199740**

LEVEL C

(Ground Level)
Scale 1:200

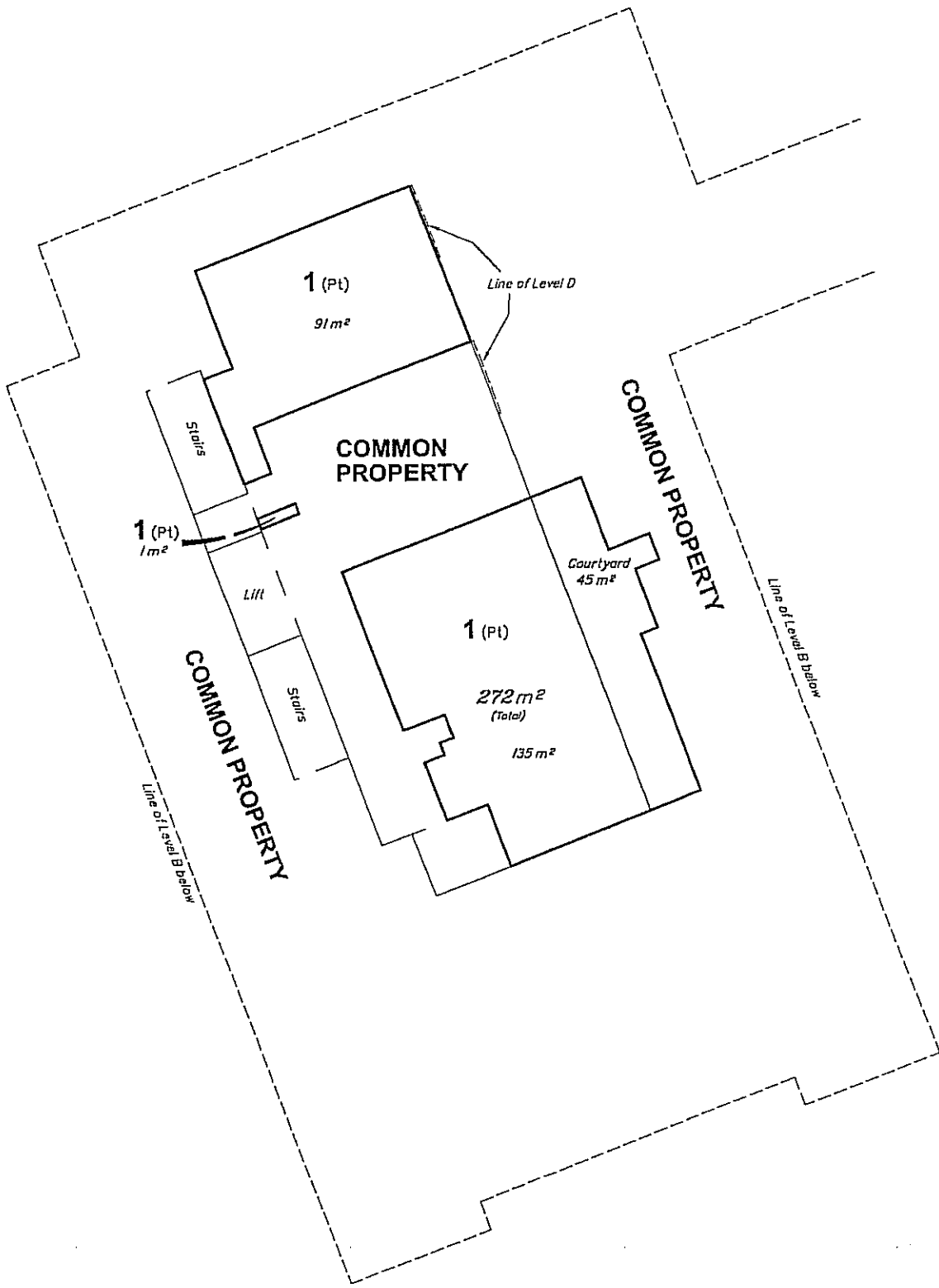

SCALE 1:200

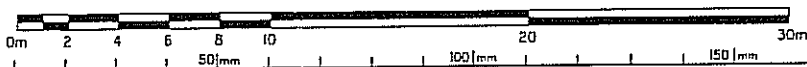

State copyright reserved.

Insert Plan Number **SP199740**

BENNETT & BENNETT 06-176 (06-176)P.L.E.DING MCH Rev E 14/7/08

LEVEL D

(Level 1)
Scale 1:200

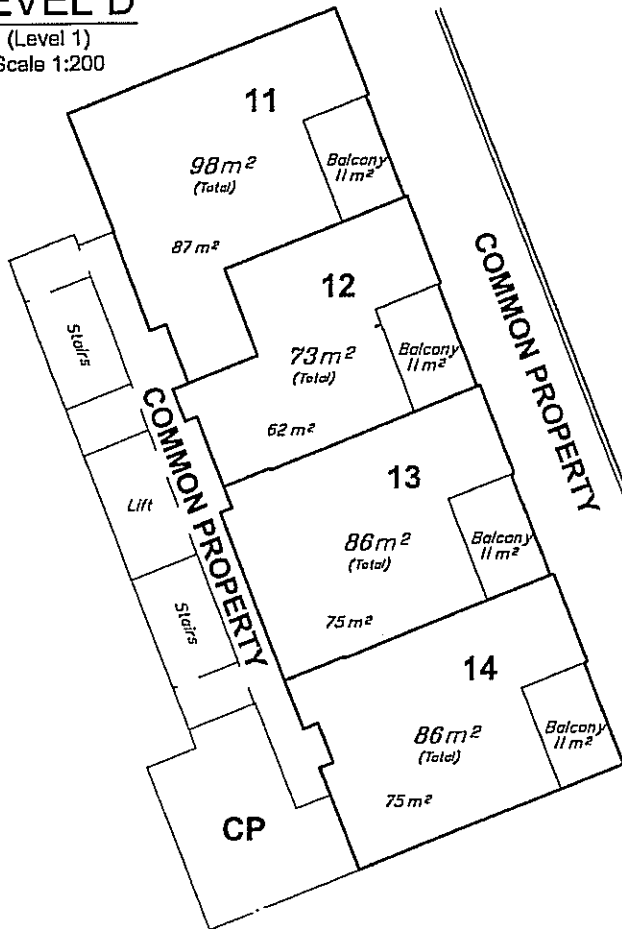

LEVEL E

(Level 2)
Scale 1:200

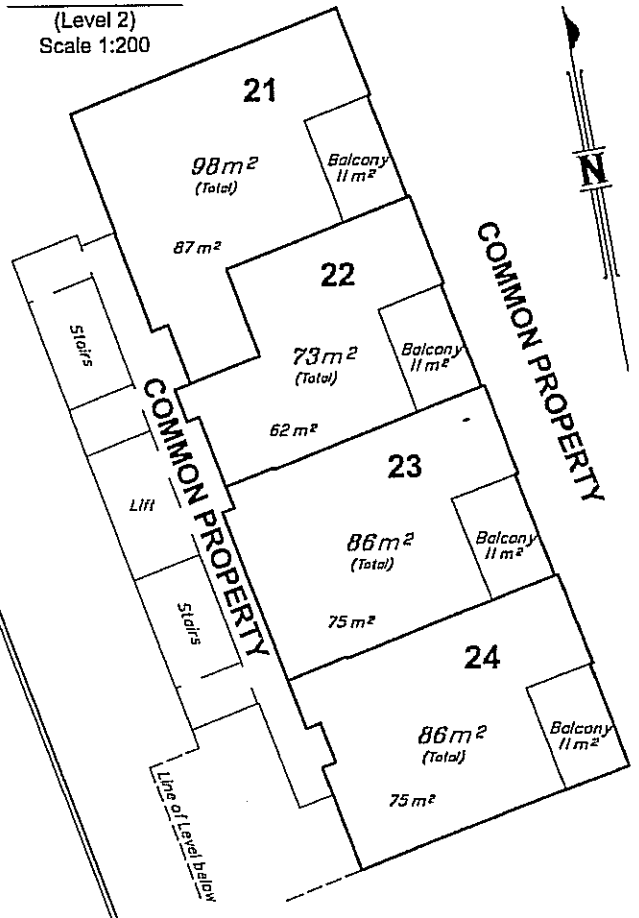

LEVEL F

(Level 3)
Scale 1:200

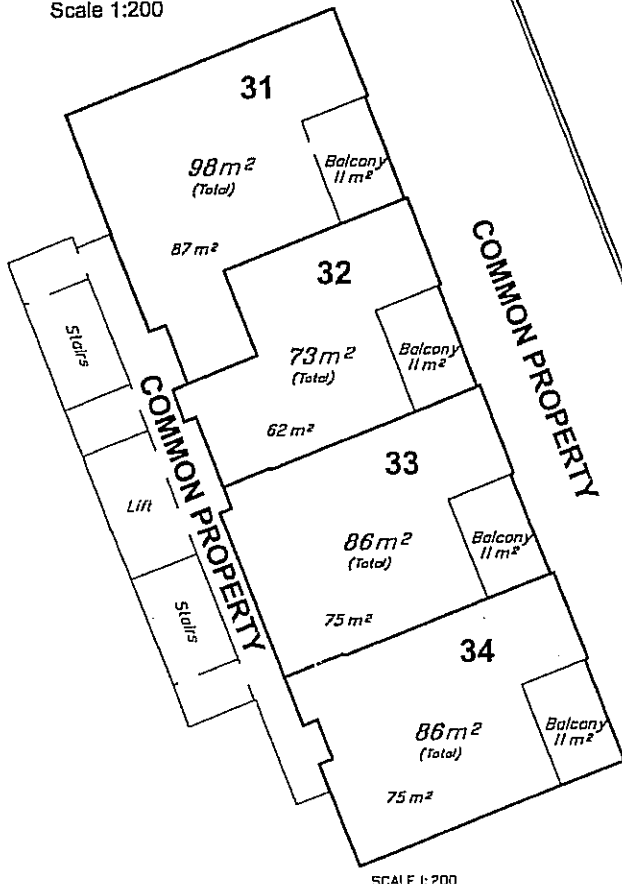

LEVEL G

(Level 4)
Scale 1:200

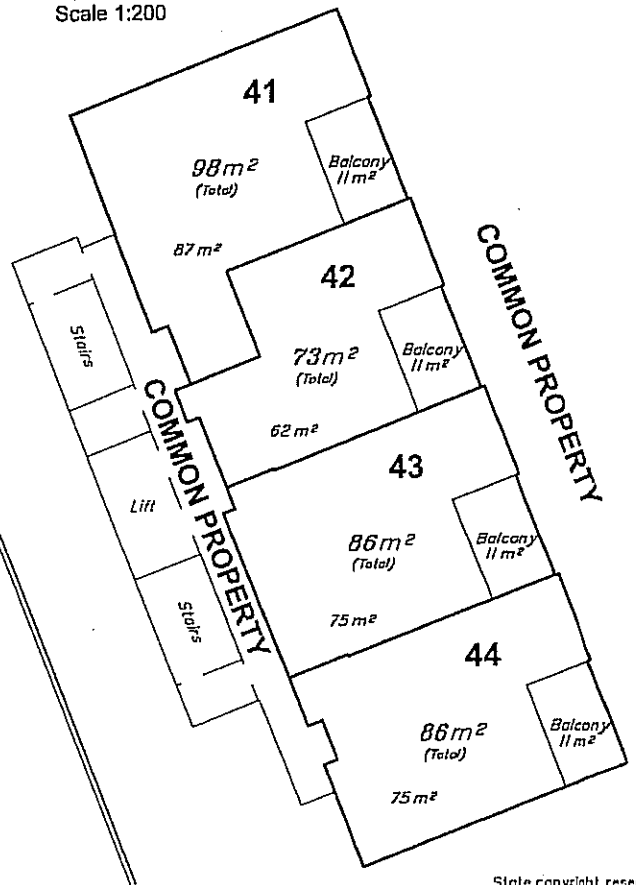

SCALE 1:200

State copyright reserved.



Insert Plan Number **SP199740**

LEVEL H

(Level 5)
Scale 1:200

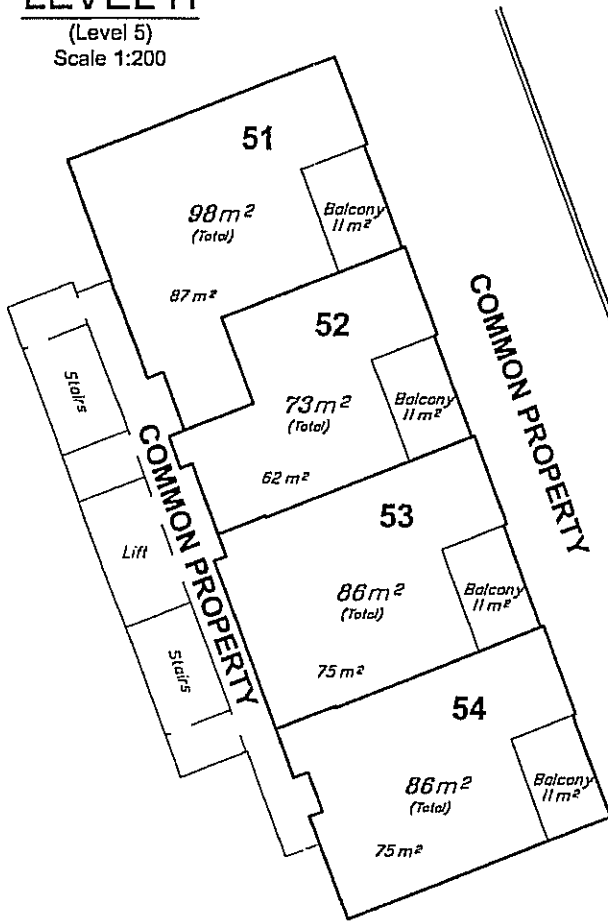

LEVEL I

(Level 6)
Scale 1:200

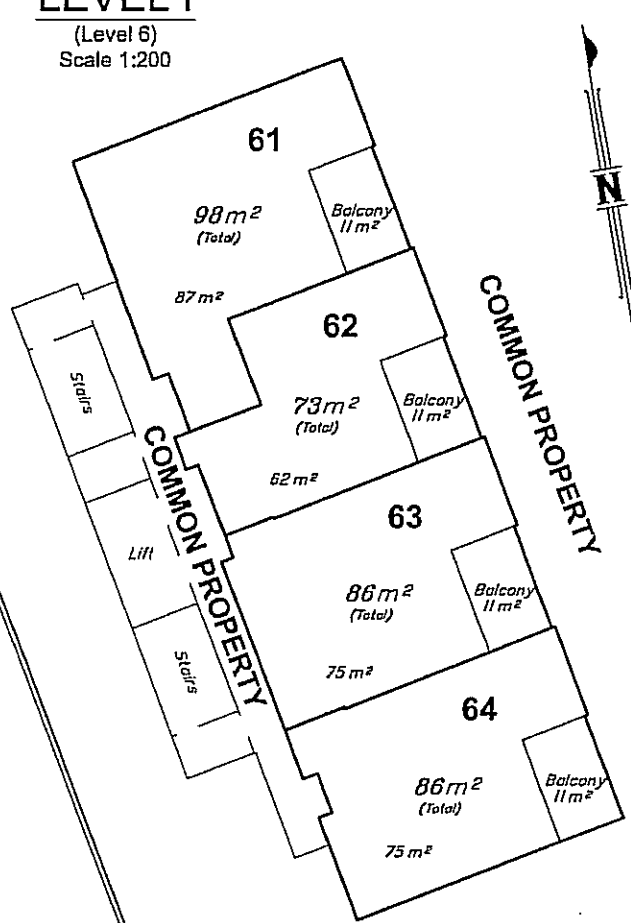

LEVEL J

(Level 7)
Scale 1:200

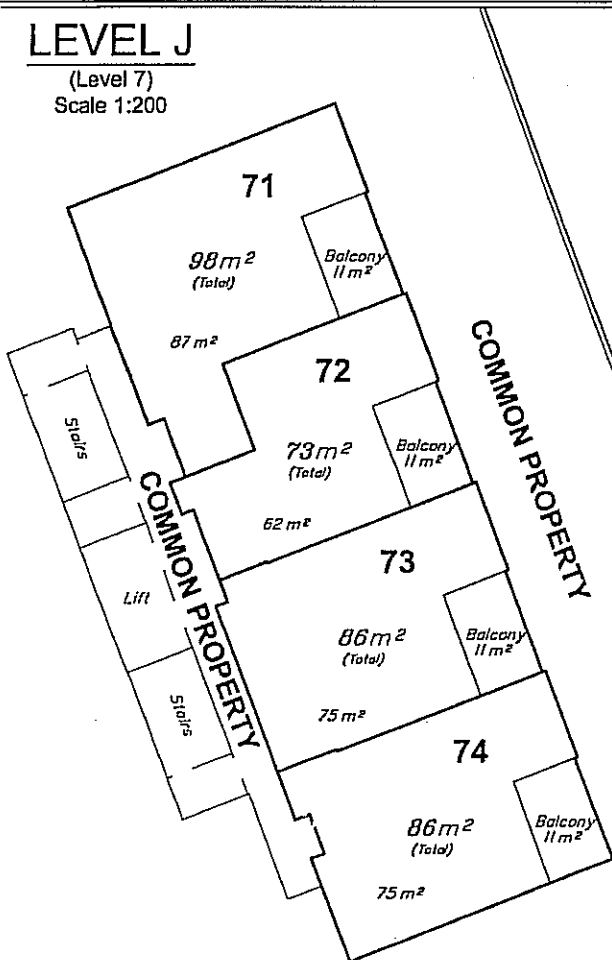

LEVEL K

(Level 8)
Scale 1:200

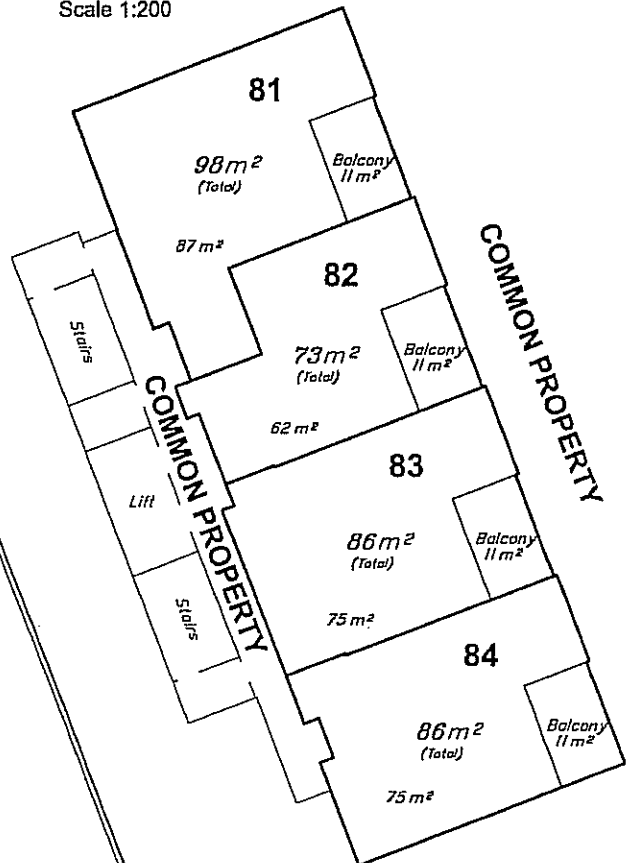

SCALE 1:200



State copyright reserved.

Insert Plan Number SP199740

LEVEL L

(Level 9)
Scale 1:200

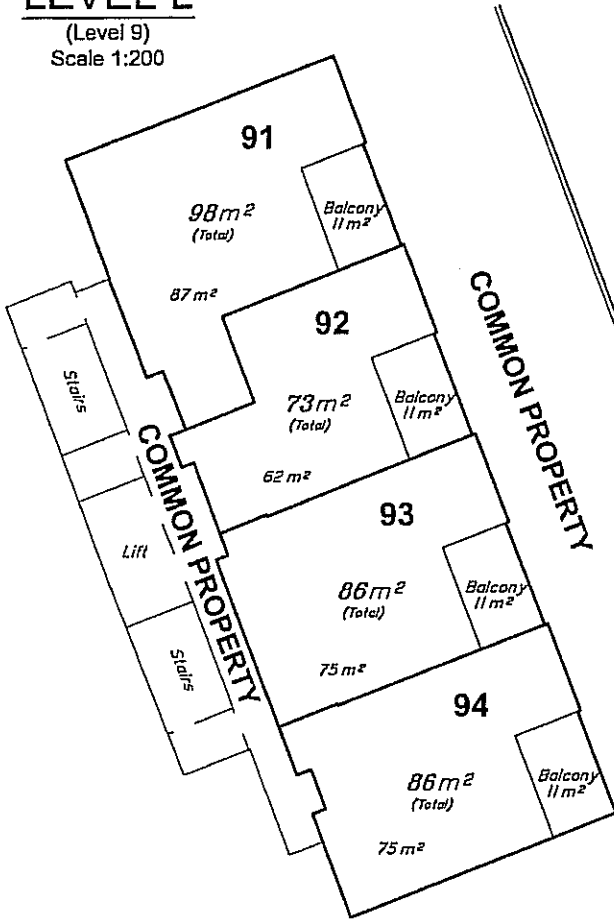

LEVEL M

(Level 10)
Scale 1:200

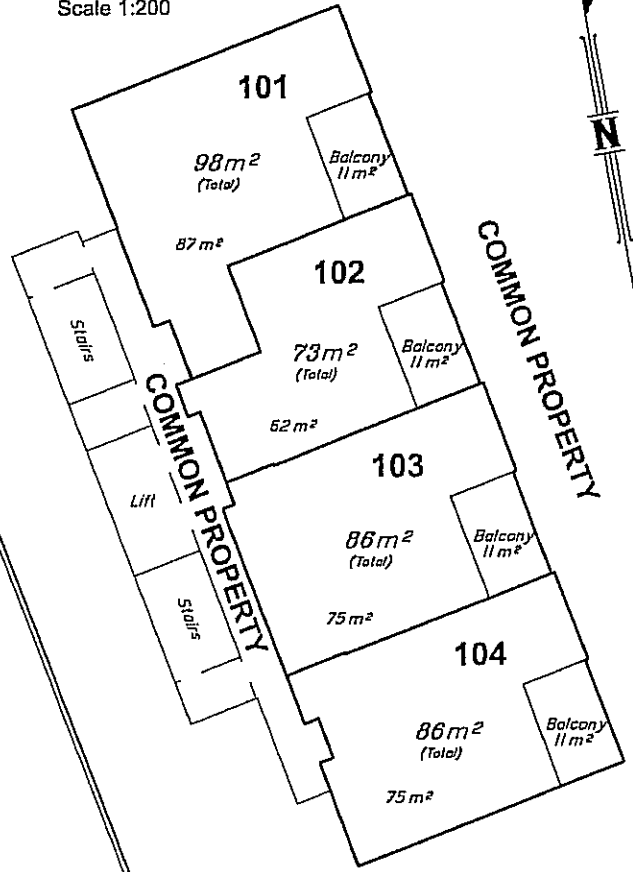

LEVEL N

(Level 11)
Scale 1:200

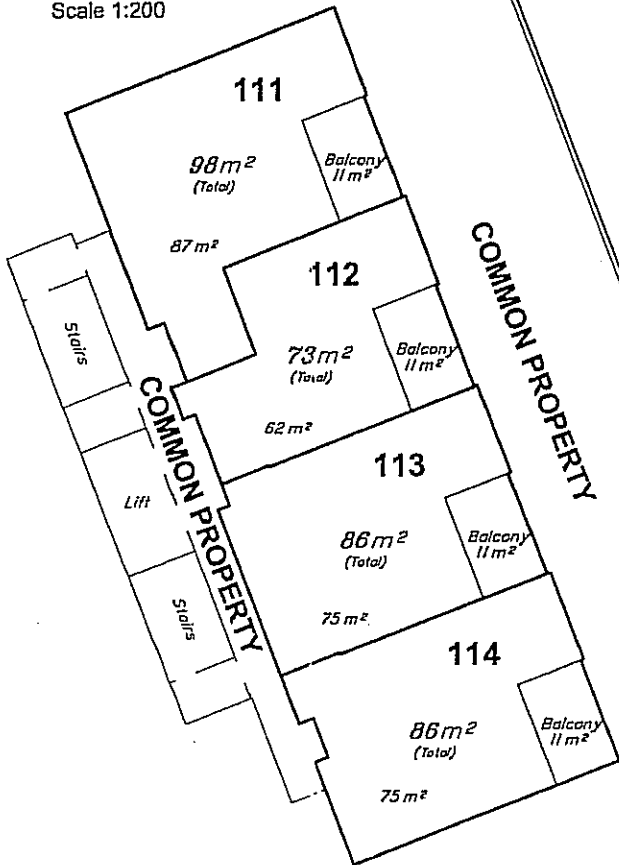

LEVEL O

(Level 12)
Scale 1:200

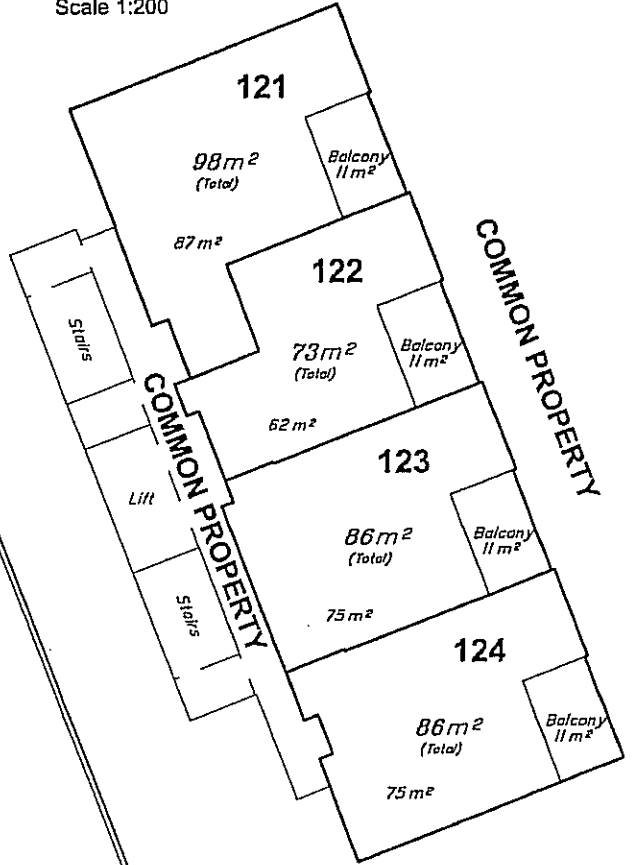

SCALE 1:200



State copyright reserved.

Insert Plan Number **SP199740**

LEVEL P

(Level 13)
Scale 1:200

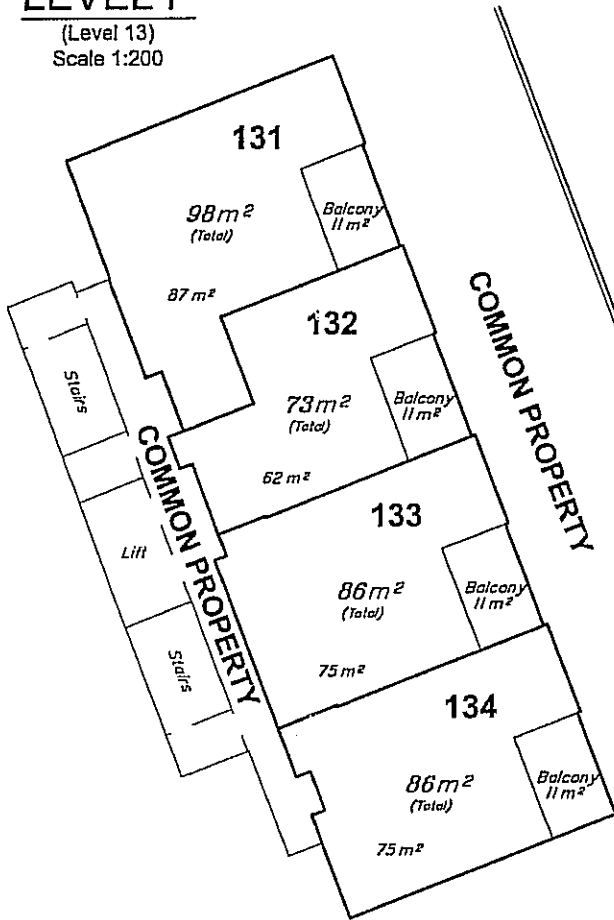

LEVEL Q

(Level 14)
Scale 1:200

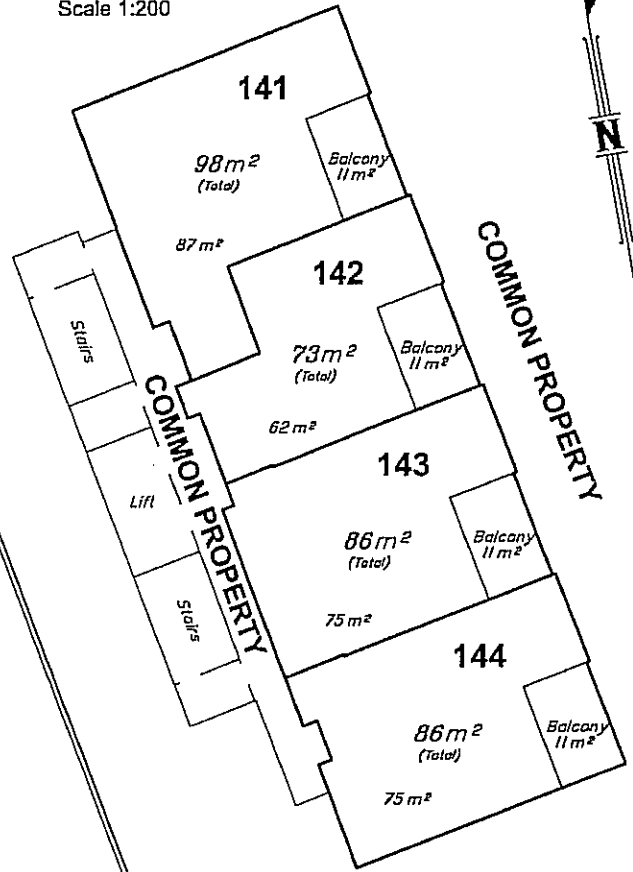

LEVEL R

(Level 15)
Scale 1:200

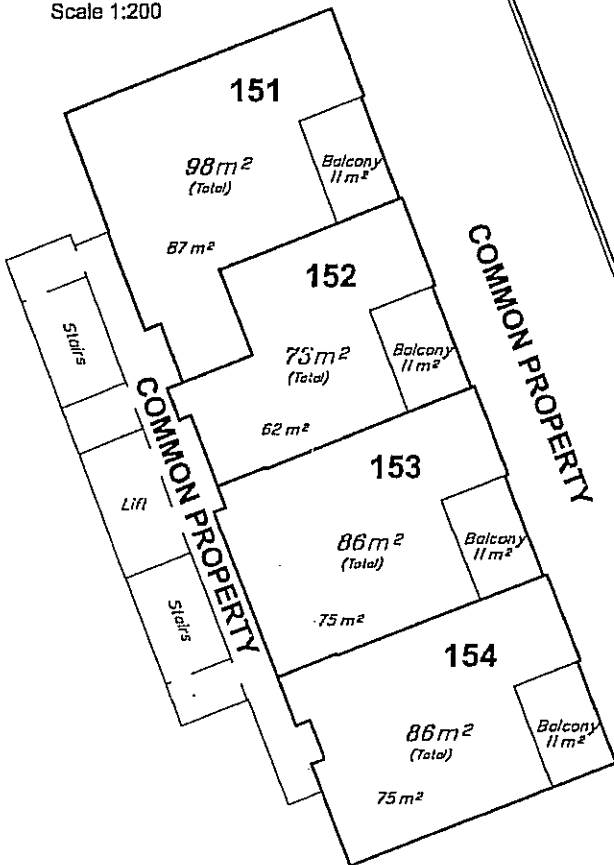

LEVEL S

(Level 16)
Scale 1:200

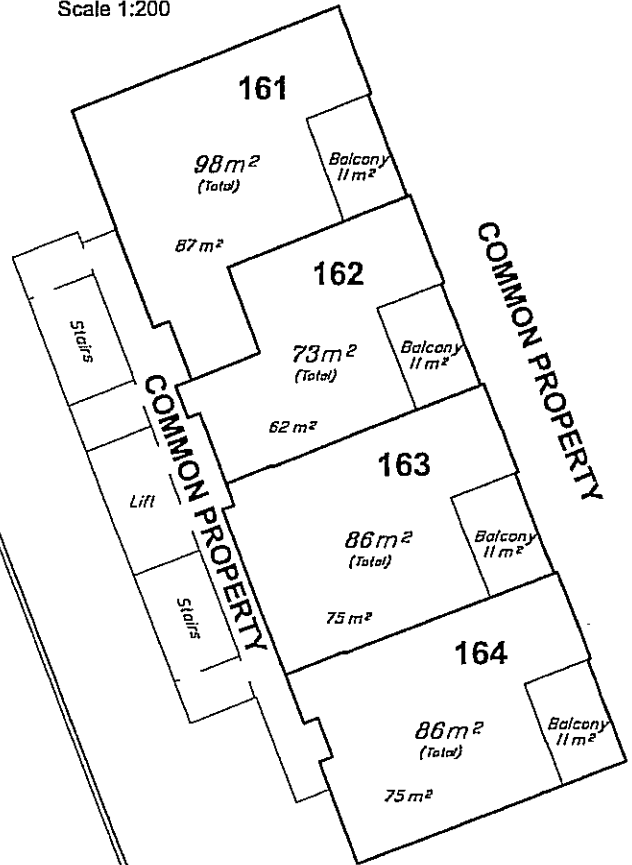

SCALE 1:200

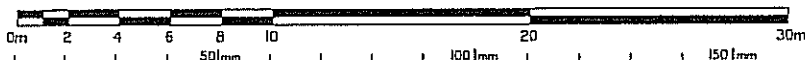

State copyright reserved.

Insert Plan Number SP199740

LEVEL T

(Level 17)
Scale 1:200

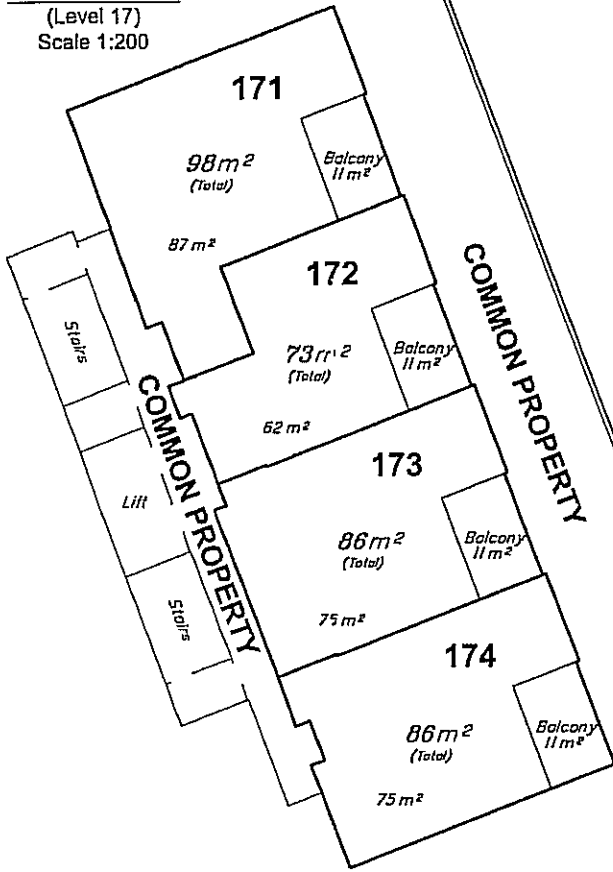

LEVEL U

(Level 18)
Scale 1:200

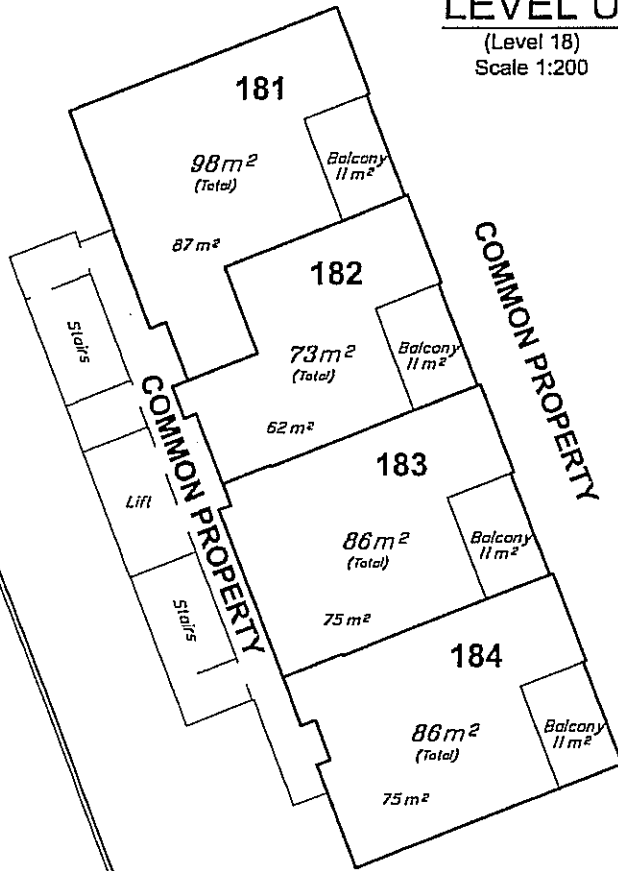

LEVEL V

(Level 19)
Scale 1:200

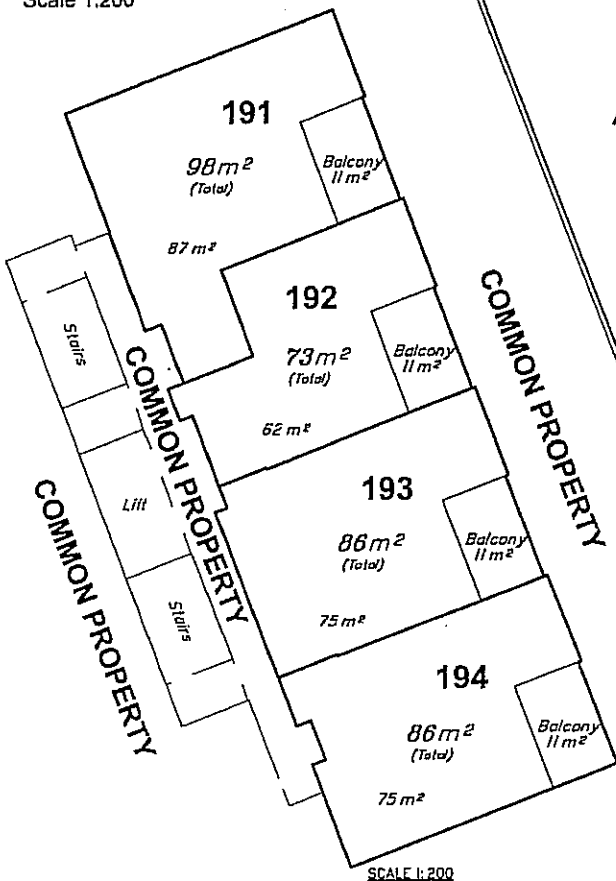

LEVEL W

(Level 20)
Scale 1:200

For Section A-A'
See Sheet 10

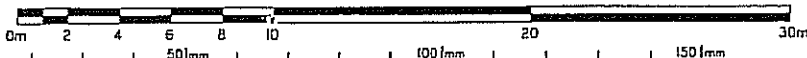
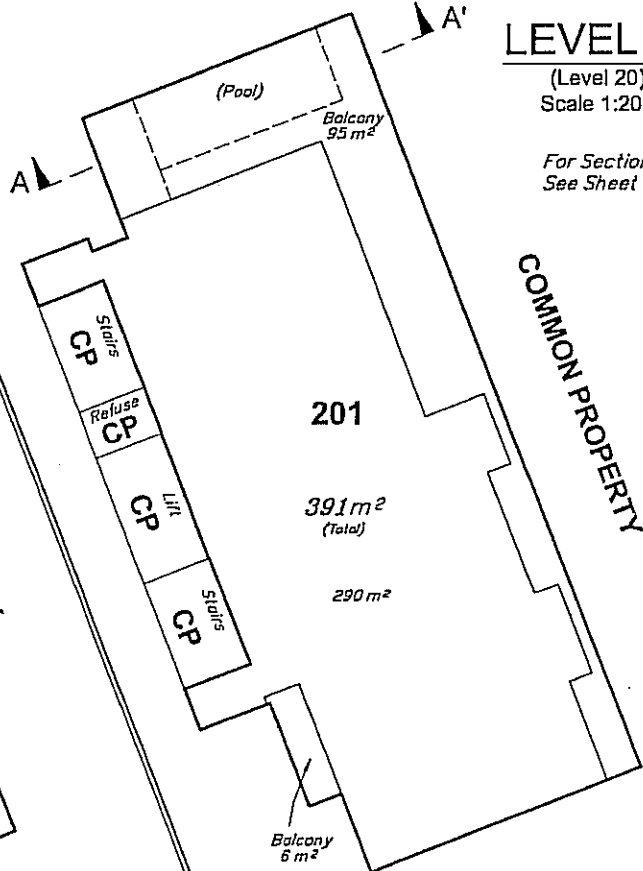

State copyright reserved.

Insert Plan Number **SP199740**

BENNETT & BENNETT 06-476 (06-4768FP_E-DWG) MCH Rev E 14/7/08

LEVEL X

(Roof)
Scale 1:200

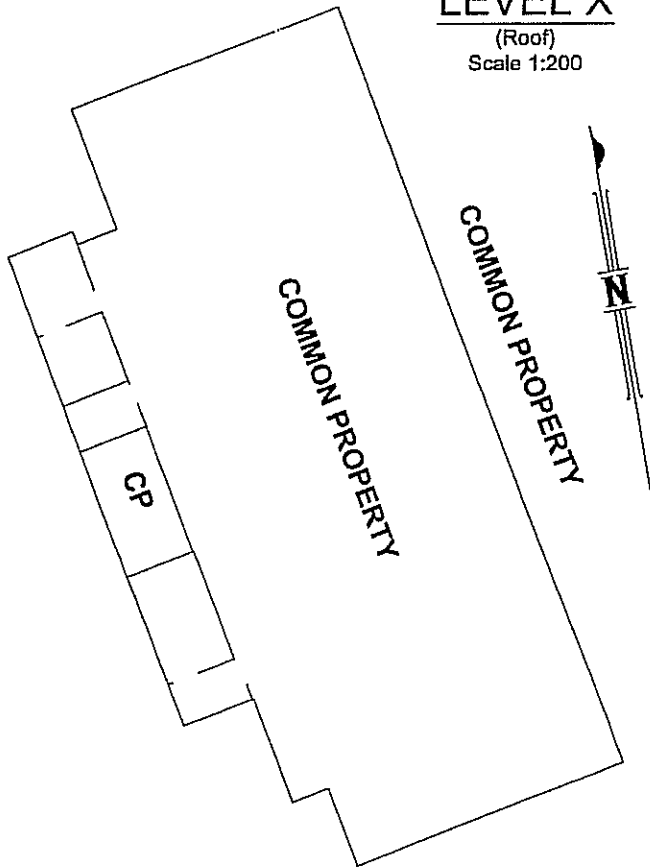

SECTION A-A'

Not to Scale

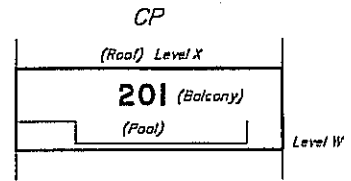

Portion Allocation

| Lots | Orig |
|---|----------------------------|
| 14, 24, 34, 44, 54, 64, 74, 84, 94, 104, 114, 124, 134, 144, 154, 164, 174, 184 & 194 | Allots 25 & 26 Sec35 |
| 13, 23, 33, 43, 53, 63, 73, 83, 93, 103, 113, 123, 133, 143, 153, 163, 173, 183 & 193 | Allot 26 Sec35 |
| 12, 22, 32, 42, 52, 62, 72, 82, 92, 102, 112, 122, 132, 142, 152, 162, 172, 182 & 192 | Allots 1 & 26 Sec35 |
| 11, 21, 31, 41, 51, 61, 71, 81, 91, 101, 111, 121, 131, 141, 151, 161, 171, 181 & 191 | Allot 1 Sec35 |
| CP | Allots 1, 2, 25 & 26 Sec35 |
| 1 & 201 | Allots 1, 25 & 26 Sec35 |

Mortgage Allocation

| Mortgage | Lots Fully Encumbered | Lots Partially Encumbered |
|------------------------|--|---------------------------|
| 712002601 710199099 | 1, 11-14, 21-24, 31-34, 41-44, 51-54, 61-64, 71-74, 81-84, 91-94, 101-104, 111-114, 121-124, 131-134, 141-144, 151-154, 161-164, 171-174, 181-184, 191-194 & 201 | --- |
| 712002606 710353588 | 1, 11-14, 21-24, 31-34, 41-44, 51-54, 61-64, 71-74, 81-84, 91-94, 101-104, 111-114, 121-124, 131-134, 141-144, 151-154, 161-164, 171-174, 181-184, 191-194 & 201 | --- |
| 712002612 710353575 | 1, 11-14, 21-24, 31-34, 41-44, 51-54, 61-64, 71-74, 81-84, 91-94, 101-104, 111-114, 121-124, 131-134, 141-144, 151-154, 161-164, 171-174, 181-184, 191-194 & 201 | --- |
| 710006143 | --- | --- |
| 710006153 | --- | --- |
| 710006156 | --- | --- |