

Annexure B
Detailed boundary map of Industrial Park and Botany Site

PLAN FORM 2(A2)

WARNING: CHECKING OR FOLDING WILL LEAD TO REJECTION

ethan This is sheet 1 of my plan in 1 sheets

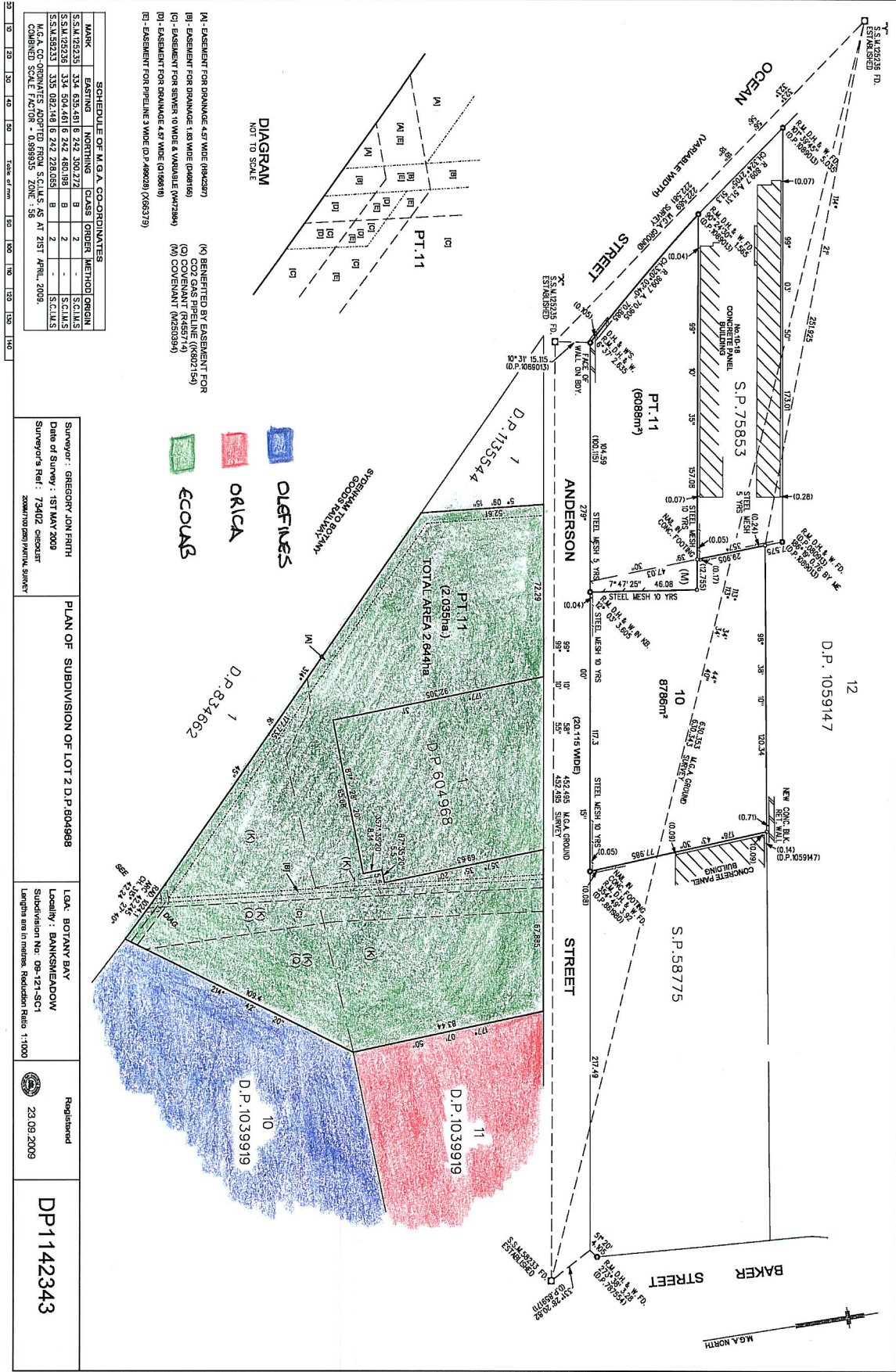

SCHEDULE OF M.G.A. CO-ORDINATES

MARK	STATION	COORDINATE	CO-ORD. METHOD	ORDIN.	SCALES
S.M.195315	342.8041	872980.72	B	2	1:500
S.M.195316	342.8041	872980.72	B	2	1:500
S.M.195317	342.8041	872980.72	B	2	1:500
S.M.195318	342.8041	872980.72	B	2	1:500
S.M.195319	342.8041	872980.72	B	2	1:500
S.M.195320	342.8041	872980.72	B	2	1:500
S.M.195321	342.8041	872980.72	B	2	1:500
S.M.195322	342.8041	872980.72	B	2	1:500
S.M.195323	342.8041	872980.72	B	2	1:500
S.M.195324	342.8041	872980.72	B	2	1:500
S.M.195325	342.8041	872980.72	B	2	1:500
S.M.195326	342.8041	872980.72	B	2	1:500
S.M.195327	342.8041	872980.72	B	2	1:500
S.M.195328	342.8041	872980.72	B	2	1:500
S.M.195329	342.8041	872980.72	B	2	1:500
S.M.195330	342.8041	872980.72	B	2	1:500

M.G.A. CO-ORDINATES ADAPTED FROM S.C.M.S. AS AT 21ST APRIL, 2009.
 COORDINATE SCALE FACTOR = 0.999935 ZONE = 19

- (A) - EASEMENT FOR DRAINAGE 4.57 WIDE (H/25M)
- (B) - EASEMENT FOR DRAINAGE 1.83 WIDE (H/16M)
- (C) - EASEMENT FOR SEWER 10 WIDE & VARIABLE (H/25M)
- (D) - EASEMENT FOR DRAINAGE 4.57 WIDE (H/25M)
- (E) - EASEMENT FOR PIPELINE 3 WIDE (D.P. 449221) (X/85379)
- (K) - BENEFITED BY EASEMENT FOR CO2 GAS PIPELINE (K/85714)
- (L) - COVENANT (K/85714)
- (M) - COVENANT (M/25354)

SYMBOLS TO FOLLOW

- OLFINES
- ORICA
- ECOLOG

Surveyor: GREGORY JOHN FRITH
 Date of Survey: 18T MAY 2009
 Surveyor's Ref.: 73402 CHECKART
 2009/10/09/PROVINCIAL SURVEY

PLAN OF SUBDIVISION OF LOT 2 D.P. 804968

L.G.A. BOTANY BAY
 Locality: BANKSIA MEADOW
 Subdivision No: 09-121-SC1
 Lengths and in metres. Reduction Ratio: 1:1000

Registered
 23.09.2009

DP1142343